

PRISMONT



Sanding Belt Holder for lathes

1.0 INTRODUCTION

A tool for sanding and deburring on conventional lathes. Indeed, you can sand and deburr without the direct use of hands (for safety). The tool is fixed to the existing tool post of the conventional lathes. It allows sanding operations of metal parts, alloy and wood. A manually operated crank allows rotation of the abrasive belt (this index is needed for a more efficient sanding). This tool is designed to fit the different diameters of parts sanded. It also allows quick change abrasive belt (details 4.0).

1.1 LIMITATION OF RESPONSIBILITY AND LIMITED WARRANTY

On no account can the value of the warranty exceed the value of the services provided to the Purchaser and paid by this one. The Purchaser gives up expressly any complaint on warranty beyond this limit. Apart from a case of grave fault on its part, the Vendor/Service provider cannot be held responsible toward the Purchaser of any fault and any damage, direct or indirect, being able to ensue from it, and the Purchaser holds the quits and unhurt Vendor/Service provider of any complaint, including any complaint on warranty, in the one or other one of the following cases: modifications brought to the contents by someone other than the Vendor/Service provider or his representative; illegal or non-authorized intervention of any third party in the equipment of the Purchaser.

Except when otherwise planned in the present contract, on no account the Vendor/Service provider (including, if necessary, his subsidiaries, and his parent company as well as his shareholders, managers, executives, employees, coworkers and subcontractors) can be held responsible toward the Purchaser or any third party of any indirect, incidental, special, punitive or exemplary damage, including in a not restrictive way any loss of profit or the other economic loss (ensuing from a contractual fault, from a liable to penalty fault or from negligence) even if the Vendor/Service provider was warned of the possibility that such a damage may occur. Because some jurisdiction forbids the exclusion or the limitation of responsibility for consequential or incidental damage, it is possible that the one or some of the exclusions or the limitations abovementioned does not apply. It is as well possible as the Purchaser has other rights, which rights can vary from a place to another. The value of the warranty can on no account exceed the value of the services provided to the Purchaser and paid by this one. The Purchaser gives up expressly any complaint on warranty beyond this limit.

1.2 OBJECTIVES OF CONTENTS

The purpose of this document is not simply to provide instructions on the operation and equipment, but mainly to ensure that the work of the operator can be conducted safely. It contains information on the technical aspects, operation, maintenance and spare parts. The instructions are an integral part of the safety equipment. This document is essential for the proper use of the product and must always be available for immediate consultation. This document should not in any case be duplicated, reproduced or transmitted electronically or by photography, without the prior permission of the manufacturer / distributor. If in doubt regarding the interpretation of the instructions, refer to the manufacturer or distributor to obtain the necessary clarifications. All operations that require assembly or disassembly of parts must be assigned to qualified personnel.

1.3 CONSERVATION

The instruction manual should be kept close to the machine and, above all, protected against liquid and any other items that might reduce readability.

Instruction Manual MST-SBH 1.0/2.0/4.0/4.0 EX

2.0 GENERAL INFORMATION

2.1 DISTRIBUTOR INFORMATIONS

PRISMONT, a division of Montfort International Ltd.
850 Boul. Pierre-Bertrand, bureau 360, Qc, Canada, G1M 3K8
Phone number: 418-877-0778

3.0 SPARE PARTS

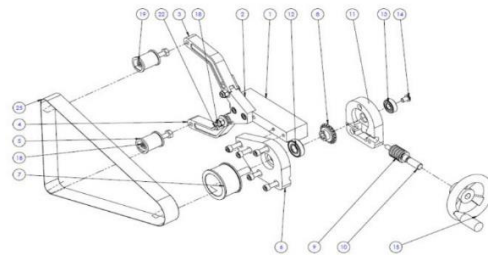

N° PIÈCE	NAME OF PART	DESCRIPTION	QTY
1	Support porte outil		1
2	Support des bras		1
3	Bras	Bras supérieur	1
4	Bras	Bras inférieur	1
5	Roue pression		2
6	Support roue principale		1
7	Roue menante		1
8	Worm gear		1
9	Worm		1
10	Shaft du worm		1
11	Boîtier roue principale		1
12	Roulement à bille		1
13	Roulement à bille		1
15	Manivelle		1
21	Spacer ressort		2
22	Block ressort		1
25	Courroie de papier sablé 1x30		1
26	Bloc bras haut		1

3.1 TECHNICAL ASSISTANCE

Contact directly your supplier or technical service that can provide you with the necessary information for the identification of the tool. Serial number and date of purchase

3.2 TECHNICAL DETAILS

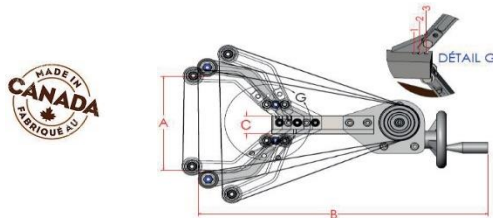

SBH1.0	Max.Ø	A	B	C	Belt
	6"	6 1/4"	13"	3/4"	1" X 30"
	(150)	(160)	(325)	(19)	(25 X 762)
SBH2.0	Max.Ø	A	B	C	Belt
	8"	8 1/2"	14"	3/4"	2" X 36"
	(200)	(215)	(350)	(19)	(50 X 915)
SBH4.0	Max.Ø	A	B	C	Belt
	12"	13"	16"	1"	4" X 54"
	(300)	(330)	(400)	(25)	(100 X 1372)
SBH4.0 EX	Max.Ø	A	B	C	Belt
	20"	22"	16"	1"	4" X 71"
	(500)	(550)	(500)	(25)	(100 X 1800)

4.0 REPLACING THE ABRASIVE BELT

WARNING! The machine must be stopped during this operation.

In order to replace the abrasive belt, simply lift the lower arm (Fig 4.2) and remove it (Fig 4.3). Following this, reposition the new strip and gently release the arm.

4.1



Initial position

4.2



Lift the lower bar

4.3



Remove strip

5.0 INSTALLATION

WARNING! The machine must be stopped during this operation.

Place into the movable carriage of the machine tool holder (Fig 5.1). Then attach securely to the transverse instrumentation platform (Fig 5.3).

5.1



Position on the tool post

5.2



Screw firmly

5.3



Correct position

6.0 USE

Place into the initial position (Fig 6.1), then start turning counter clockwise (for normal processing) and gently close the abrasive belt in order to get the working position as illustrated in (Fig 6.2) Then slowly turn the handle to index the abrasive belt as needed.

6.1



Initial position

6.2



Working position

*Printed in Canada



WARNING!

It is strictly forbidden, by the manufacturer and OSHA standards, to use any electrical appliance in order to accelerate the rotation of the abrasive belt. Only the use of the handle by the operator is permitted. Any other ways may hurt the security operator. No manual operation, for example SANDING and / or FILING must be performed on a moving part.

The design of this tool is based on the standard
EN.12840-2001 & ISO 23125:2010

**EXCLUSIVELY AVAILABLE IN THE
UK FROM SOLON SYSTEMS LTD**

TEL : 0121 603 1235

EMAIL : sales@sponmech.co.uk